



CPD18TVL

Li-Ion Three-Wheel Counterbalance
Forklift 1.8T **LI-ION**
TECHNOLOGY

- Large Workspace
- Compact Truck Size and Powerful Performance
- EP Lithium-ion Technology
- Enhanced Mast with Optimal Visibility & Stability
- 12-month Free Telematics System

EP EQUIPMENT CO.,LTD
www.ep-ep.com



FEATURE

Large Workspace

Due to the compact size of EP lithium battery and the ergonomic configuration of the control levers and the foot brake pedal, the small truck offers spacious legroom of 394mm and delivers the best in operation comfort.



Compact Truck Size and Powerful Performance

CPD18TVL features a small turning radius of 1550 mm and 2x5.0 kW dual drive motors, which makes it a perfect workhorse for narrow aisle warehouses for long-hour shifts.

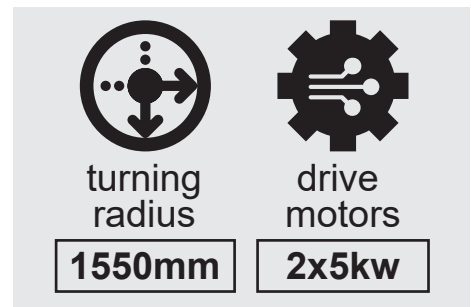

EP Lithium-ion Technology

The CPD18TVL forklift comes with a 80V EP Li-Ion battery and a 35A single phase integrated charger with 16amp plug allowing the truck to be charged at any power outlets. The big battery and the advantage of onboard charging make it ideal for forklift rental business.



Enhanced Mast with Optimal Visibility & Stability

CPD18TVL adopts the same high-strengthened mast of CPD20L2, offering the best all-around visibility and great stability with less wobbling even fully loaded. The rear axle load of this truck is enhanced to ensure superior longitudinal stability.

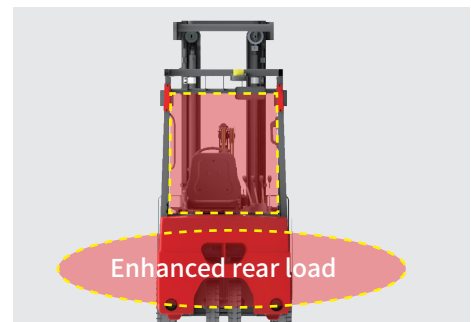

12-month Free Telematics System

CPD18TVL offers EP's latest Telematics. It provides the following features to facilitate your fleet management:

- Truck location in real-time
- Reports of truck usages and diagnosis
- Li-ion battery condition analytics



Li-Ion Three-Wheel Counterbalance Forklift 1.8T

CPD18TVL

Distinguishing mark	1.1	Manufacturer			EP
	1.2	Model designation			CPD18TVL
	1.3	Drive			Electric
	1.4	Operator type			Seated
	1.5	rated capacity	Q	kg	1800
	1.6	Load center distance	c	mm	500
	1.8	Load distance, centre of drive axle to fork	x	mm	420
	1.9	Wheelbase	y	mm	1330
Service weight	2.1	Service weight		kg	3269
	2.2	Axle loading, laden front/rear		kg	4415/654
	2.3	Axle loading, unladen front/rear		kg	1368/1901
Tyres/chassis	3.1	Tyre type		mm	Solid rubber
	3.2	Tyre size, front		mm	18X7-8
	3.3	Tyre size, rear		mm	15X4.5-8
	3.5	Wheels, number front/rear (x=drive wheels)		mm	2X/2
	3.6	Tread width, front	b10	mm	943
	3.7	Tread width, rear	b11	mm	175
	4.1	Tilt of mast/fork carriage forward/backward	α/β	°	6/7
Dimensions	4.2	Height, mast lowered	h1	mm	2075
	4.3	Free lift	h2	mm	100
	4.4	Lift height	h3	mm	3000
	4.5	Height, mast extended	h4	mm	4055
	4.7	Height of overhead guard (cabin)	h6	mm	2078
	4.8	Seat height/standing height	h7	mm	1050
	4.12	Tow coupling height	h10	mm	600
	4.19	Overall length	l1	mm	2833
	4.20	Length to face of forks	l2	mm	1913
	4.21	Overall width	b1/b2	mm	1070
	4.22	Fork dimensions	s/e/l	mm	100X40X920
	4.23	A,B Fork carriage class/type A, B			2A
	4.24	Fork carriage width	b3	mm	1040
	4.31	Ground clearance, laden, below mast	m1	mm	89
	4.32	Ground clearance, center of wheelbase	m2	mm	92
	4.34.1	Aisle width for pallets 1000×1200 crossways	Ast	mm	3275
	4.34.2	Aisle width for pallets 800×1200 crossways	Ast	mm	3400
	4.35	Turning radius	Wa	mm	1550
Performance data	5.1	Travel speed, laden/unladen		km/ h	13/14
	5.2	Lifting speed, laden/unladen		m/s	0.27/0.43
	5.3	Lowering speed, laden/unladen		m/s	0.44/0.435
	5.5	Drawbar pull, laden/unladen		N	—
	5.6	Max. drawbar pull, laden/unladen		N	—
	5.7	Gradeability, laden/unladen		%	10/15
	5.8	Max. gradeability, laden/unladen		%	—
	5.10	Service brake			Hydraulic
	5.11	Parking brake			Mechanical
Electric-engine	6.1	Drive motor rating S2 60 min		kW	5.0X2
	6.2	Lift motor rating at S3 15%		kW	11
	6.3	Battery according to DIN 43531 /35 / 36 A, B, C, no			No
	6.4	Battery voltage/nominal capacity		V/Ah	80/205(Li-Ion)
	6.5	Battery weight		kg	220
Addition data	8.1	Type of drive control			AC
	10.5	Steering design			Hydraulic
	10.7	Sound pressure level at the driver's ear		dB(A)	70

If there are improvements of technical parameters or configurations, no further notice will be given.
The diagram shown may contain non-standard configurations.

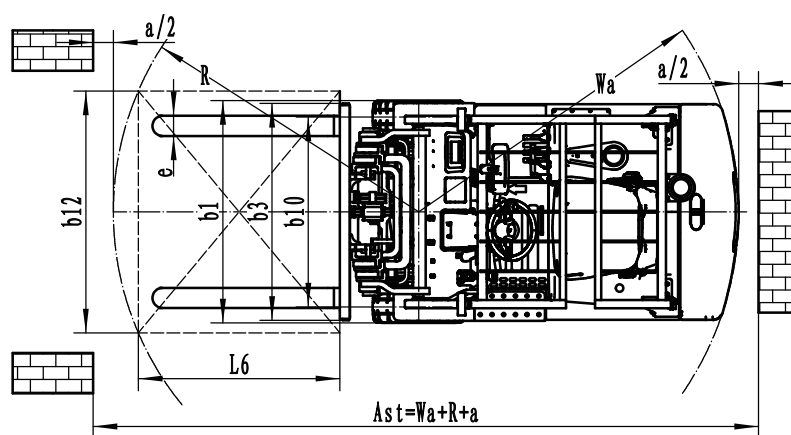
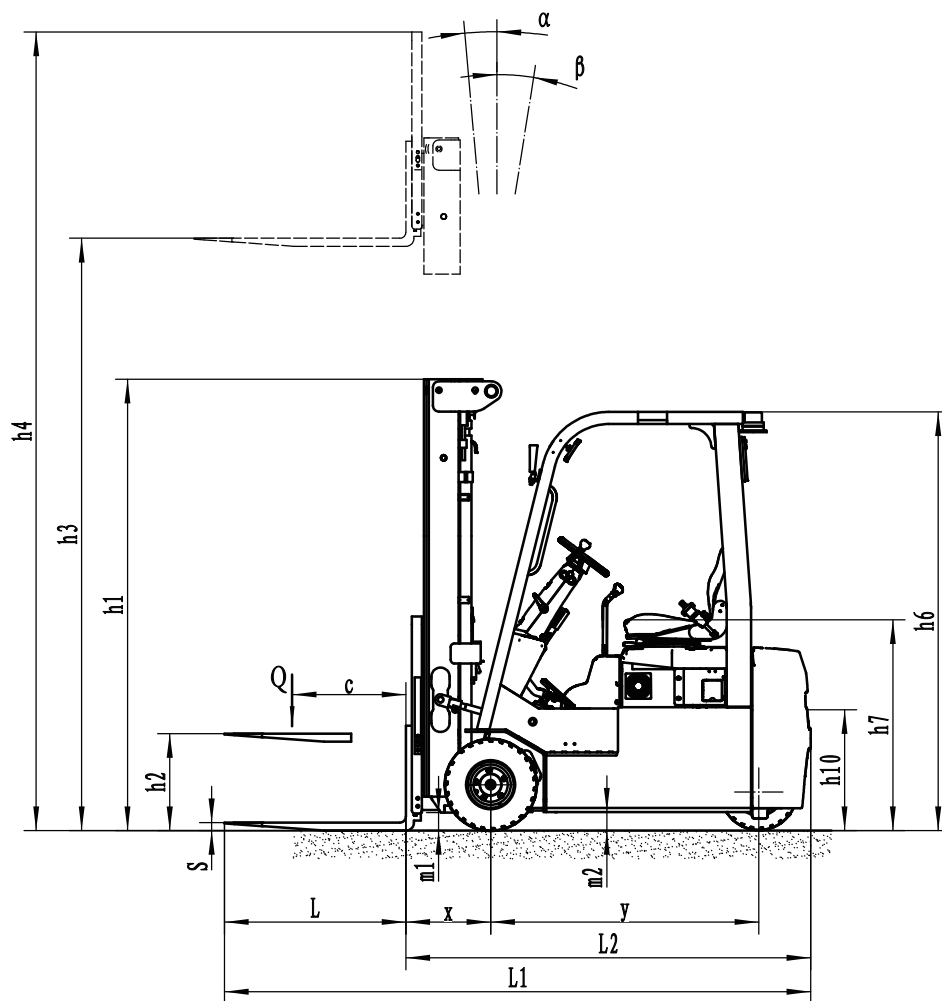

Mast Option

Mast types	Lift height (h3)	Height, Mast			Height, Free lift(h2)	
		Height, mast lowered(h1)	Height, mast extended(h4)		No backrest	With backrest
			No backrest	With backrest		
	mm	mm	mm	mm	mm	mm
2 Stage Standard Mast	3000	2075	3740	4055	100	100
	3600	2375	4340	4655	100	100
	4000	2455	4740	5055	100	100
3 Stage Free Lift Mast	4500	2140	5240	5555	1430	1115
	4800	2240	5540	5855	1530	1215
	5000	2305	5740	6055	1595	1280
	5500	2475	6240	6555	1765	1450
	6000	2690	6740	7055	1980	1665

Option

No.	Optional items	CPD18TVL
1.1	Fork length	○920●1070○1150○1220○1370
2.5	Front wheel material	●solid○non marking solid
2.6	Rear wheel material	●solid○non marking solid
2.7	Battery capacity	●205Ah(Li-Ion)
2.8	Charger	●80V-35A single-phase integrated ○80V-65A 3-phase integrated ○80V-35A single-phase external ○80V-65A 3-phase external ○80V-100A 3-phase external
2.10	Seat type	●Standard○Suspension
2.11	Attachments	●No○Built-in sideshifter○External shifter○Customization available
3.1	Foldable fork	●No○Yes and can be customized
3.6	Rear lamp	●No○LED
3.9	Blue lamp	●No○Yes and not customized
3.10	Area warning lamp	●No○Yes and not customized
3.15	Fire extinguisher	●No○Yes and not customized
3.17	OPS system	●No○Yes and not customized
4.4	Weighting system with fork	●No○Yes and not customized
Note: ●Standard ○ Optional - Inconformity		